

Straight Swivel Fittings Male

Technical Details	
Material	Stainless Steel AISI 303
Thread Type	Metric acc. to EN 60423

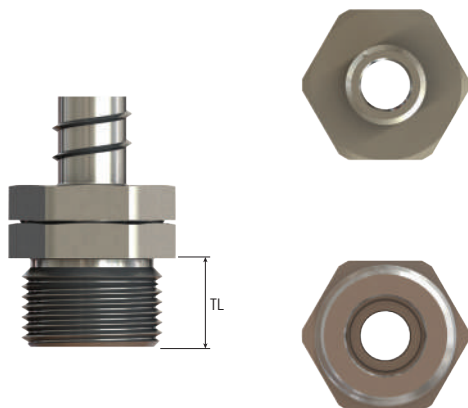

Swivel Fittings					
Outer Thread Size (Male)	For Sealrite Nominal Size	Outer Thread Length TL mm	Outer Ø D mm	Part Number	Minimum Order Quantity
M12x1,5	1/4"	8,0	15,5	BMSSW-0S	1000
M16x1,5	1/4"	10,0	18,9	BMSSW-01	500

